

**ŁAŃCUCHY ROLKOWE
STANDARD BRYTYJSKI "B"
WG NORMY: PN 77/M-84168 /
DIN 8187**

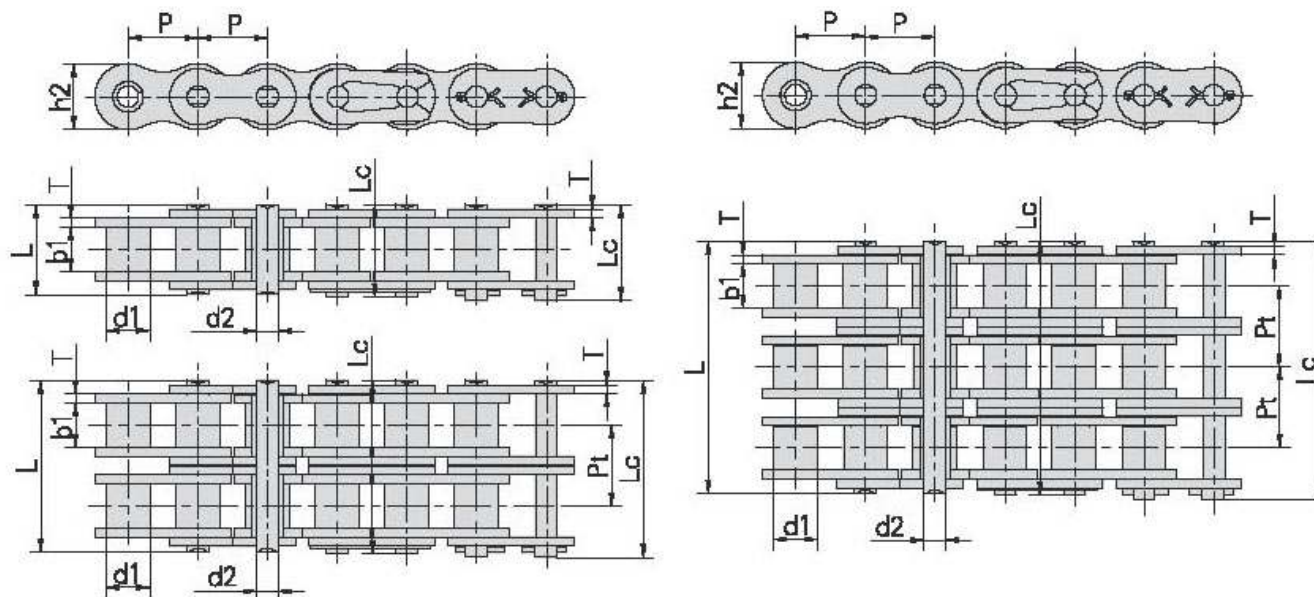

NR. DIN /ISO	Podz. P	Śred. rolki d1 max	Szer. ogniw wew. b1 min	Śred. Sworz d2 max	Szer.zewn łańcucha						Wys. plytki h2 max	Grubość plytek t / T max	Obciążenie Zrywające			Ciężar q kg / m	Ciężar q kg / m	Ciężar q kg / m
					R1		R2		R3				R1	R2	R3			
					L max	Lc max	L max	Lc max	L max	Lc max			da min	da min	da min			
04B-1	6.000	4.00	2.80	1.85	6.8	7.8					5.00	0.60	3.0			0.11		
05B-1	8.000	5.00	3.00	2.31	8.2	8.9	13.9	14.5	19.5	20.2	7.10	0.80	5.0	7.8	11.1	0.20	0.33	0.48
06B-1	9.525	6.35	5.72	3.28	13.15	14.1	23.4	24.4	33.5	34.6	8.20	1.30	9.0	16.9	24.9	0.41	0.77	1.16
08B-1	12.700	8.51	7.75	4.45	16.70	18.2	31.0	32.2	45.1	46.1	11.60	1.60	18.0	32.0	47.5	0.69	1.34	2.03
10B-1	15.675	10.16	9.65	5.08	19.60	20.9	36.1	37.5	52.7	54.1	14.70	1.70	22.4	44.5	66.7	0.93	1.84	2.77
12B-1	19.050	12.07	11.68	5.72	22.50	24.2	42.0	43.6	61.5	63.1	16.00	1.85	29.0	57.8	86.7	1.15	2.31	3.46
16B-1	25.400	15.88	17.02	8.28	36.10	37.4	68.0	69.3	99.8	101.2	21.00	4.15/3.1	60.0	106.0	160.0	2.71	5.41	8.13
20B-1	31.750	19.05	19.56	10.19	41.30	45.0	77.8	81.5	114.2	117.9	26.40	4.5/5.0	95.0	170.0	250.0	3.70	7.20	10.82
24B-1	38.100	25.40	25.40	14.63	53.40	67.8	101.7	106.2	150.1	154.6	33.20	6.0/4.8	160.0	280.0	425.0	7.10	13.40	20.10
28B-1	44.450	27.94	30.99	15.90	65.10	69.5	124.6	129.1	184.2	188.7	36.70	7.5/6.0	200.0	360.0	530.0	8.50	16.60	24.92
32B-1	50.800	29.21	30.99	17.81	66.00	71.0	124.6	129.6	183.2	188.2	42.00	7.0/6.0	250.0	450.0	670.0	10.25	21.00	31.56
40B-1	63.500	39.37	38.10	22.89	82.20	89.2	154.5	161.5	226.8	233.8	52.96	8.5/8.0	355.0	630.0	950.0	16.35	32.00	48.10
48B-1	76.200	48.26	45.72	29.24	99.10	107.0	190.4	198.2	281.6	289.4	63.80	12.0/10.0	560.0	1000.0	1500.0	25.00	50.00	75.00